

Airofog USA Wand Assemblies and Parts Diagram

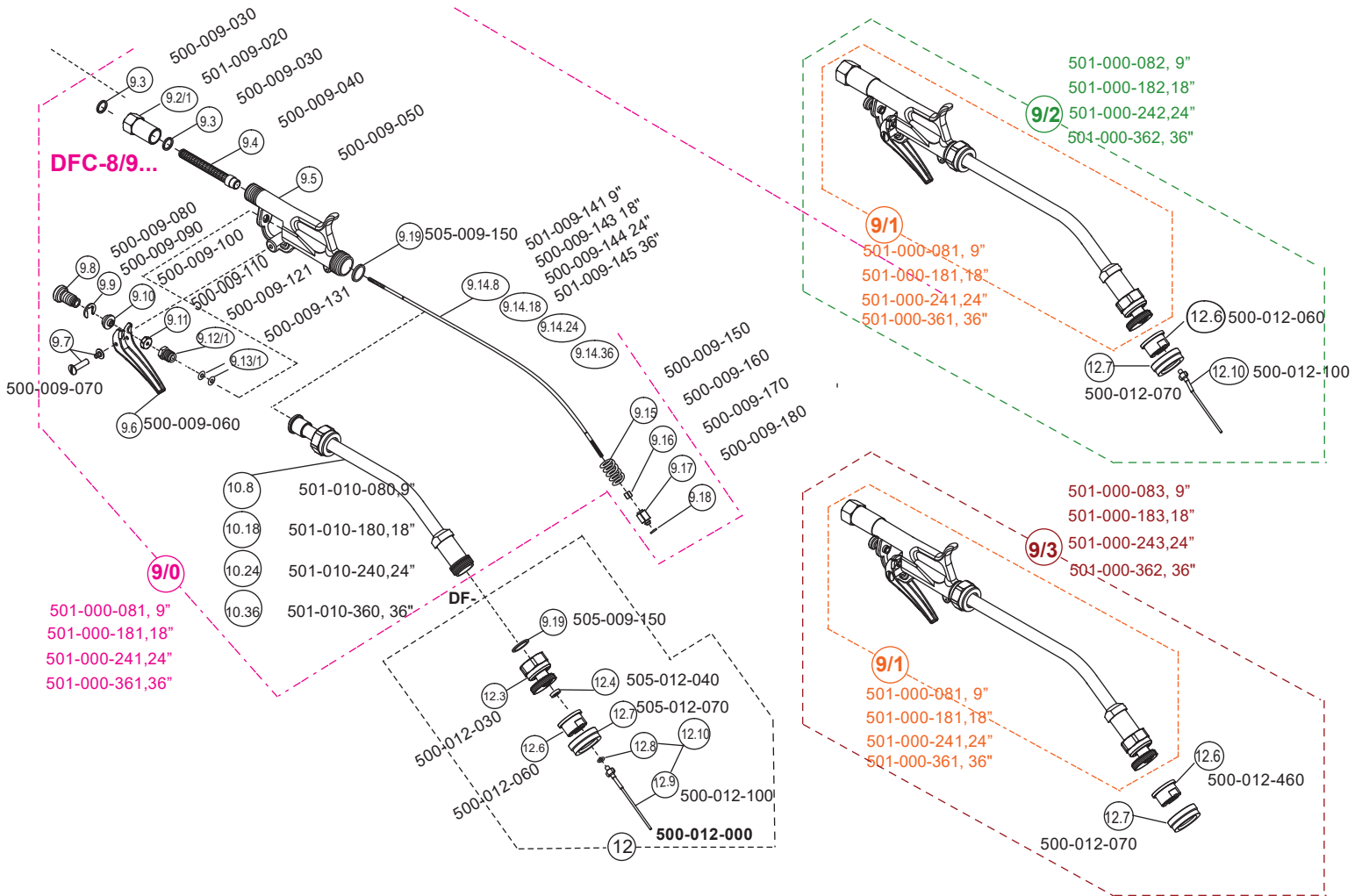

DF 9.5	500-009-050	Valve Body, includes 2 Viton Packing, packing nut	DF 12	500-012-000	Tip Holder Assembly, with C&C tip, straw & gasket
DF 9.6	500-009-060	Trigger, Valve SS	DF 12.3	500-012-030	Tip Holder, with gasket (no retainer or tip)
DF 9.7	500-009-070	Screw, Trigger	DF 12.4	500-012-040	Gasket for tip
DF 9.8	500-009-080	Safety Lock Nut	DF 12.6	500-012-060	Tip, CC
DF 9.9	500-009-090	Snap Ring SS	DF 12.7	500-012-070	Retainer (for tip)
DF 9.10	500-009-100	Screw, Adjust	DF 12.8	935-018-000	Gasket on straw
DF 9.11	500-009-110	Nut, Lock	DF 12.9	500-012-100	Straw, Pro series
DF 9.12/1	500-009-121	Packing Nut (replaces PN-150-1) Universal	DF 12.10	500-012-100	Straw, Pro series
DF 9.13/1	500-009-131	Valve Packing, Viton O-Ring (2 required for AF Valve)	.9/2	501-000-082	Valve Ext. 9" Complete Assembly 090" SS core, CC Tip & Straw
DF 9.14.8	501-009-141	VC-090 Valve Cable 9"	.9/2	501-000-182	Valve Ext. 18" Complete Assembly 090" SS core, CC Tip & Straw
DF 9.14.18	500-009-143	VC-090 Valve Cable 18"	.9/2	501-000-242	Valve Ext. 24" Complete Assembly 090" SS core, CC Tip & Straw
DF 9.14.24	500-009-144	VC-090 Valve Cable 24"	.9/2	501-000-362	Valve Ext. 36" Complete Assembly 090" SS core, CC Tip & Straw
DF 9.14.36	500-009-145	VC-090 Valve Cable 36"	.9/1	501-000-081	9" Valve Extension, SS core Complete W/retaining ring, W/O tip
DF 9.15	500-009-150	Valve Spring SS	.9/1	501-000-181	18" Valve Extension, SS core Complete W/retaining ring, W/O tip
DF 9.16	500-009-160	Nut, Seat Steam	.9/1	501-000-241	24" Valve Extension, SS core Complete W/retaining ring, W/O tip
DF 9.17	500-009-170	Seat Stem With Viton "O" Ring	.9/1	501-000-361	36" Valve Extension, SS core Complete W/retaining ring, W/O tip
DF 9.18	500-009-180	"O" Ring, Seat Stem, Viton AF Multi Purpose	DF 12.6	500-012-060	Tip, CC
DF 9.19	505-009-150	Valve Extension Gasket	DF 12.7	500-012-070	Retainer (for tip)
DF 10.8	501-010-080	Valve Extension, VE - 090" SS Core	DF 12.10	500-012-100	Straw, Pro series
DF 10.18	501-010-180	Valve Extension, VE - 180" SS Core	DF 9.2/1	501-009-020	Strainer, Housing
DF 10.24	501-010-240	Valve Extension, VE - 240" SS Core	DF 9.3	500-009-030	Nylon Gasket, Strainer Housing
DF 10.36	501-010-360	Valve Extension, VE - 360" SS Core	DF 9.4	500-009-040	Strainer, 50 MESH